

# AUTO CUT CB 70P



CE EN60974-7

CODE	↔		
PA1290	6 m	19.7'	1/8 GAS
PA1291	6 m	19.7'	CENTRAL

TECHNICAL DATA		
	HF	
	0,6 kg	1.43 lb
	500	
	5 bar	
	170 l/min	
	70A	
	50A	
	18÷24 mm	

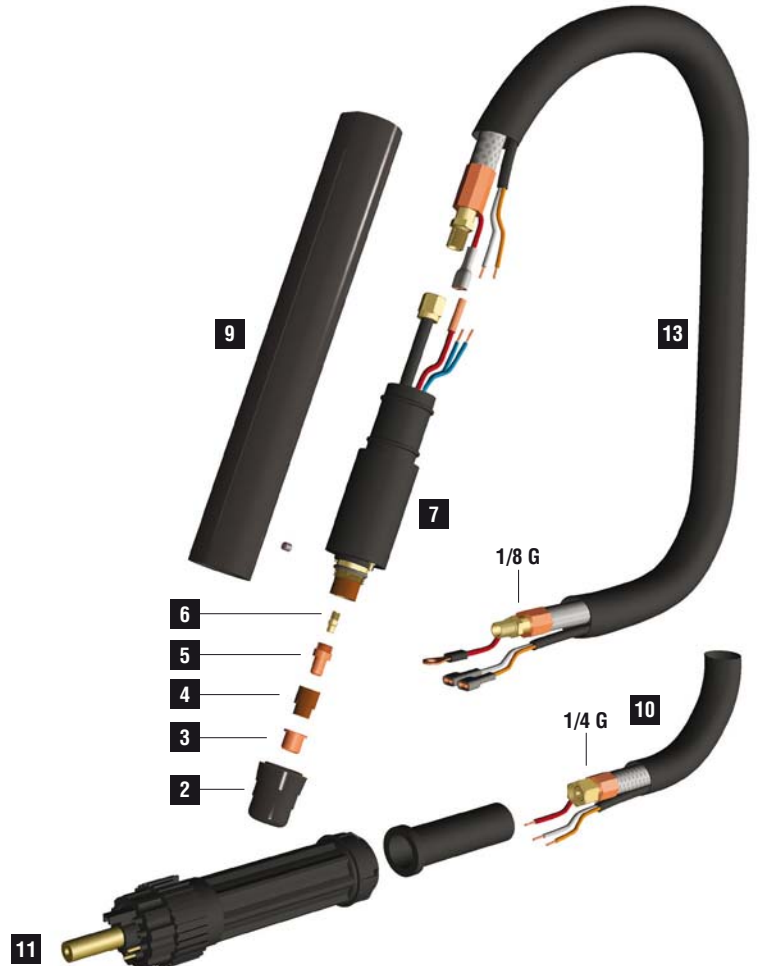
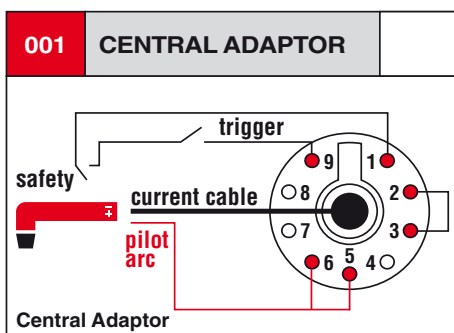
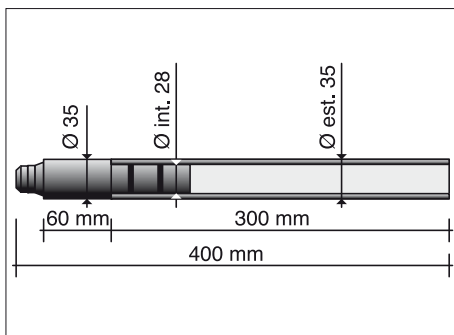

	CODE		Ø		CONTACT		REF	
2	PC0032				31,5 mm		5710171	2
3	PD0088-06		20 A	0,65 mm	.025"	12,3 mm		10
3	PD0088-08		40 A	0,8 mm	.030"	12,3 mm		10
3	PD0088-10		50 A	1,0 mm	.040"	12,3 mm		1396
3	PD0088-11		60 A	1,1 mm	.043"	12,3 mm		10
3	PD0088-12		70 A	1,2 mm	.045"	12,3 mm		1308
4	PE0007		plasma diffuser					20101
5	PR0063	plasma electrode			17,8 mm		1402	10
6	FH0211							

	CODE	
7	EA0221	10
7	PF0028	plasma torch head
7	PT0031	repair kit
9	TP0061	1
10	PH0170	6 m - 1/4 G

	CODE	
10	QB0097	cover (mt)
11	CY0002	cable support
11	FY0014	central adaptor
13	PH0172	6 m - 1/8 G

STANDARD

CONTACT SHORT

CONTACT LONG